

CLOW CANADA

350mm - 500mm RW GATE VALVE
with SPUR GEAR or BEVEL GEAR
all styles MATERIAL LIST

PROJECT

OWNER

CONTRACTOR

DISTRIBUTOR

CONSULTANT

CLOW MODEL 2638 - AWWA C515
REDUCED WALL DUCTILE IRON

ITEM NO.	DESCRIPTION	MATERIAL	ASTM SPEC.
1	Body	Ductile Iron	ASTM A536 65-45-12
2	Cover	Ductile Iron	ASTM A536 65-45-12
3	Wedge	Ductile Iron/Rubber	ASTM A536 65-45-12 ASTM D-2000
4	Wedge Cap (18"-24" only)	Delrin	Delrin
5	Cover O ring	Rubber	ASTM D-2000
6	Stem O/L or O/R	Bronze	ASTM B584 C86700
7	Stem Nut	Bronze	ASTM B584 C86700
9	O ring	Rubber	ASTM D-2000
10	Cover Hex Head Bolt	Stainless Steel	ASTM F 593
11	Cover Hex Nut	Stainless Steel	ASTM F 593
12	Extension	Ductile Iron	ASTM A536 65-45-12
13	Lower Ext O ring	Rubber	ASTM D-2000
14	Follower Hex Head Bolt	Stainless Steel	ASTM F 593
15	Actuator - 3:1 (18"-20") 2:1 (14-16")	As purchased	AWWA C515
16	Adaptor Plate	Ductile Iron	ASTM A536 65-45-12
17	Actuator Gasket	Rubber	ASTM D-2000
18	Socket Head Bolt	Alloy Steel	Alloy Steel
19	Upper Ext O ring	Rubber	ASTM D-2000
20	Adapter Plate Hex Bolt	Stainless Steel	ASTM F 593
21	Adapter Plate Hex Nut	Stainless Steel	ASTM F 593
22	Key	Steel	-----
23	Op Nut	Ductile Iron	ASTM A536 65-45-12
24	Pipe Plug - 1/2 NPT with square hd	Stainless Steel	AISI 304
28	Thrust Bearing (18"-20" only)	Delrin	Delrin
29	Track Pipe Plug	Stainless Steel	AISI 304

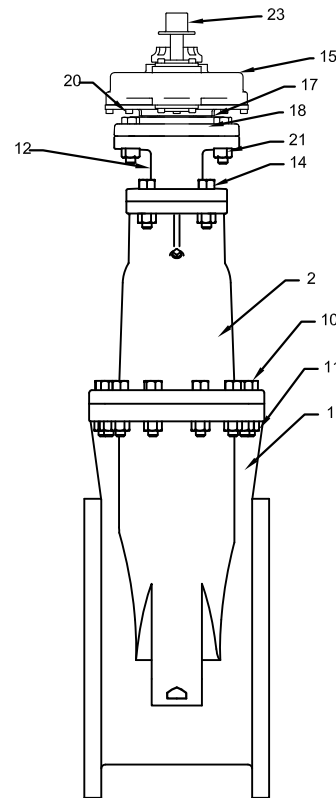

APPLICATIONS
FIRE WATER
POTABLE WATER

NOTES:

All valves 18" diameter & larger are equipped with 3:1 gear operators
Spur (vertical installation) or Bevel (horizontal)
14 & 16" diameter valves are supplied with 2:1 gear operators by special request only
All geared valves 14" diameter & larger are available with position indicators by special request.
Geared gate valves are not ULC or FM approved

FIGURE #	AVAILABLE GATE VALVE END CONNECTIONS	SIZE
F-6102	FLG End (NRS) (ANSI B16.1 Class 125)	14"- 20"
F-6100	M.J. (ANSI A-21.11)	14"- 20"
F-6106	FLG x M.J.	14"- 20"
F-6112	Tyton for D.I. & C900 PVC (AWWA C111/A21.11)	14"- 16"

TEST DATA

Size Range	Rated Working water pressure PSI	Bubble Tight test PSI	Hydrostatic Shell test PSI
AWWA 16" -20"	250	250	500

CERTIFICATIONS

Electrostatically applied Epoxy coating per **AWWA C550** complies with **NSF 61**
NSF/ANSI 372 COMPLIANT -DRINKING WATER SYSTEMS
COMPONENTS - LEAD CONTENT
80 - 90% RECYLCED CONTENT as defined by **LEED -New Construction and Major Renovation version 2.2**

PHYSICAL PROPERTIES

Temperature range- 32 to 125 degrees Fahrenheit / 0 to 52 degrees Celsius
250 PSI /17.2 bar non - shock cold working pressure
100% full port - smooth waterway no pockets or cavities
Valve has been cycle tested 5,000 times without loss of bubble-tight seal
Valve has been subjected to torques 150 percent of the designated minimum required torques

OPTIONAL SPUR GEAR or BEVEL GEAR OPERATOR

