



KENNEDY VALVE

C515 4" - 20" RESILIENT WEDGE GATE VALVE

CERTIFICATIONS

ISO 9001

ISO 14001

ISO 45001

AWWA C515



*Listings specific to product

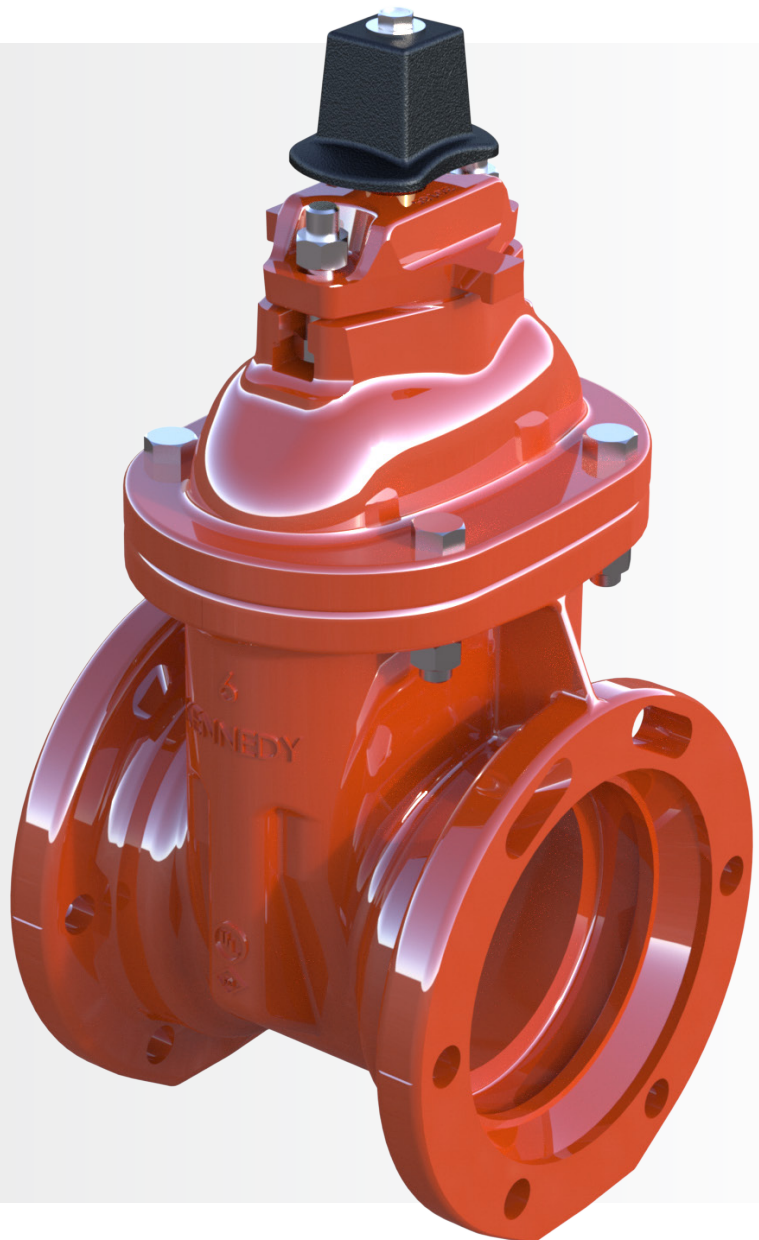

WWW.KENNEDYVALVE.COM

In the early 1980's Kennedy recognized and increased the requirements and escalating maintenance cost of water systems in the United States. Kennedy responded by introducing the first RW (Resilient Wedge) Valve in America. This introduction revolutionized the valve market in the U.S. Kennedy was the first to introduce, and still leads in, the design and technical development of the bubble tight resilient seating valve. The RW Valve, with its unique features and benefits, is the first to be manufactured with both AWWA and UL/FM approval for all water system requirements.

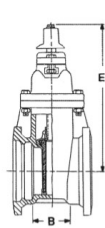

7571
Mechanical Joint
4"-20"

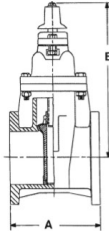

7561A
Flanged
4"-20"

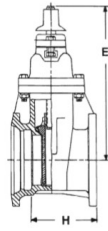

7572
Flanged X
Mechanical Joint
4"-12"

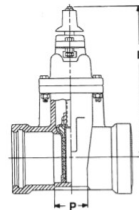

7595
Push on for
SDR PVC
4"-12"

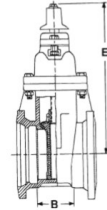

7576
Mechanical
Cutting in Joint
4"-12"

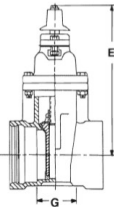

7901
Tyton Ends for D.I.
and C900 PVC Pipe
4"-16"

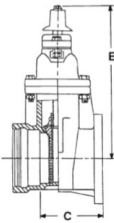

7902
Flanged x Tyton
4"-12"

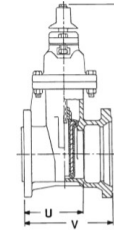

7950
Tapping x MJ
Tapping Valve
4"-20"

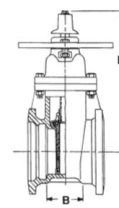

7071
Mechanical Joint
Post Indicator Valve
4"-16"

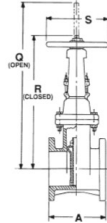

7068A
Flanged OS&Y
4"-12"

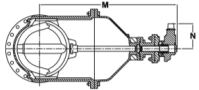

Bevel Gearing
Horizontal Installation
All End Styles
14"-20"

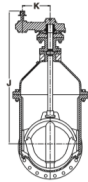

Spur Gearing
Vertical Installation
All End Styles
14"-20"

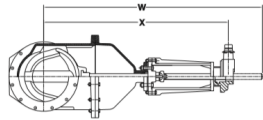

OS&Y Bevel Gearing
Horizontal Installation
All End Styles
14"-20"

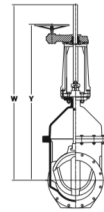

OS&Y Spur Gearing
Vertical Installation
All End Styles
14"-20"

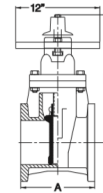

7701A
Flanged Post
Indicator Valve
4"-16"

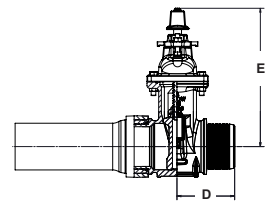

HDPE
AWWA Only
IPS DR11 FM Approved
4"-12"

NOTE: It is recommended that valves be installed with stems vertical when used in raw sewage or sludge applications or in water with excessive sediment. Flanged end connections not recommended for buried service.

**No. of Turns
to Full Open**

| VALUE SIZE | A | B | C | D | E | G | H | J | K | M | N | P | Q | R | S | U | V | NO GEAR | GEARED | W | X | Y | |
|------------|--------|--------|--------|---------|--------|--------|--------|--------|----|--------|--------|-------|--------|--------|----|--------|--------|---------|--------|--------|--------|--------|--|
| 4" | 9 | 4-1/2 | 6-3/4 | 6-1/8 | 14-3/4 | 4-5/8 | 6-3/4 | | | | | 4-1/2 | 22-3/4 | 18-1/4 | 10 | 6-3/4 | 9-1/4 | 13-1/2 | | | | | |
| 6" | 10-1/2 | 5-1/2 | 7-7/8 | 7-13/16 | 19 | 5-1/4 | 8 | | | | | 5 | 30-1/8 | 23-3/4 | 12 | 8 | 10-1/2 | 19-1/2 | | | | | |
| 8" | 11-1/2 | 8-1/8 | 8-1/2 | 9-1/8 | 22-1/2 | 5-5/8 | 9-3/4 | | | | | 5-1/2 | 37-3/4 | 29-1/4 | 14 | 10-3/4 | 13-1/4 | 25-1/2 | | | | | |
| 10" | 13 | 10-1/2 | 10 | 11-3/8 | 26-1/2 | 7 | 11-3/4 | | | | | 7 | 45-3/4 | 35-3/8 | 18 | 11-3/4 | 14-7/8 | 31-1/2 | | | | | |
| 12" | 14 | 10-3/4 | 11-1/4 | 11-3/4 | 30 | 8-1/2 | 12-7/8 | | | | | 8-1/2 | 53-1/8 | 40-3/8 | 18 | 12-3/8 | 15 | 37-3/4 | | | | | |
| 14" | 15 | 10 | | | 37-3/4 | 10-1/2 | 13-1/2 | 52-1/8 | 8 | 48-5/8 | 9-1/8 | | 74-3/4 | 59-3/4 | 22 | 13-1/4 | 16-3/4 | 52 | 100 | 76 | 59-7/8 | 64-1/2 | |
| 16" | 16 | 10 | | | 37-3/4 | 10-1/2 | 13 | 51-1/8 | 8 | 47-5/8 | 9-1/8 | | 74-3/4 | 59-3/4 | 22 | 12-3/4 | 16-1/4 | 52 | 100 | 76 | 59-7/8 | 64-1/2 | |
| 18" | 17 | 11-3/4 | | | | | 14-7/8 | 58 | 12 | 55-3/4 | 10-1/8 | | | | | 14-5/8 | 16-1/8 | | 189 | 90-7/8 | 70-1/8 | 74-5/8 | |
| 20" | 18 | 11 | | | | | 14-1/2 | 57 | 8 | 54-3/4 | 10-1/8 | | | | | 14-1/2 | 18 | | 189 | 90-7/8 | 70-1/8 | 74-5/8 | |

NRS with POST PLATE

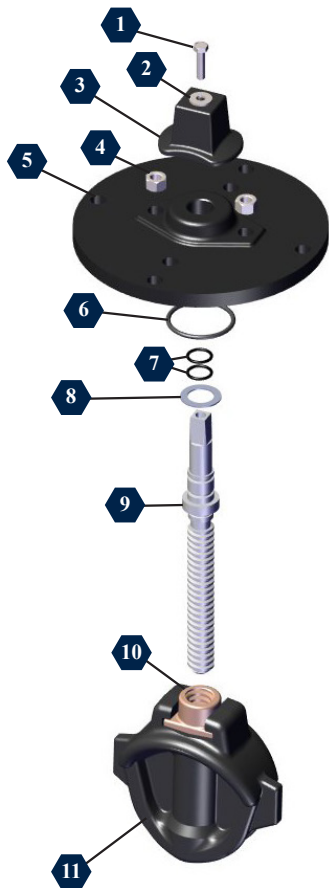

NRS

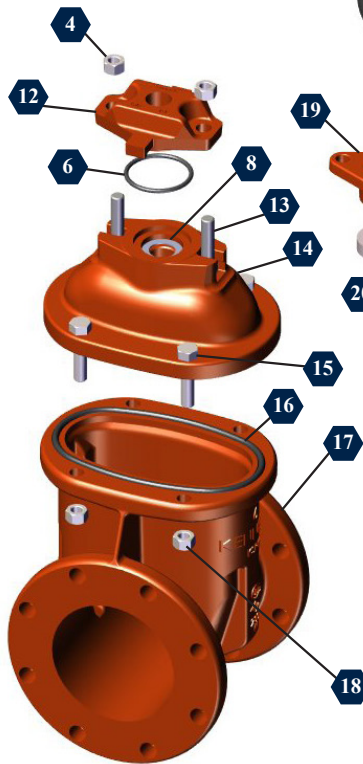

OS&Y



| NO. | DESCRIPTION | MATERIAL | NO. | DESCRIPTION | MATERIAL |
|-----|--------------------------------------|--------------------------------|-----|-----------------------|------------------|
| 1 | Op-Nut Bolt | Stainless Steel | 17 | Body | Ductile Iron |
| 2 | Op-Nut Washer | Stainless Steel | 18 | Cover / Body Nut | Stainless Steel |
| 3 | Op-Nut | Ductile Iron | 19 | Packing Gland | Ductile Iron |
| 4 | Post Plate / Stuffing Box Nut | Stainless Steel | 20 | Packing | Garlock Style 18 |
| 5 | Post Plate | Cast Iron | 21 | OS&Y Wheel Nut | Bronze |
| 6 | Post Plate / Stuffing Box O-Ring | Rubber | 22 | Hand Wheel | Cast Iron |
| 7 | Stem O-Rings | Rubber | 23 | OS&Y Cover | Ductile Iron |
| 8 | Thrust Teflon Washer | Plastic | 24 | OS&Y Yoke Washer | Plastic |
| 9 | NRS Stem | Stainless Steel | 25 | OS&Y Yoke Nut | Bronze |
| 10 | NRS Stem Nut | Bronze | 26 | Packing Stud | Stainless Steel |
| 11 | Resilient Wedge | EPDM Encapsulated Ductile Iron | 27 | OS&Y Stem | Stainless Steel |
| 12 | Stuffing Box | Ductile Iron | 28 | OS&Y Stem O-Ring | Rubber |
| 13 | Post Plate / Stuffing Box Plate Bolt | Stainless Steel | 29 | OS&Y Stem Pin | Stainless Steel |
| 14 | NRS Cover | Ductile Iron | 30 | OS&Y Stem Head | Stainless Steel |
| 15 | Cover / Body Bolt | Stainless Steel | 31 | Handwheel Yoke Washer | Brass |
| 16 | Cover / Body O-Ring | Rubber | | | |

SPECIFICATIONS & FEATURES

Kennedy Valve AWWA C515 Resilient Wedge Gate

Valves meet or exceed the requirements of AWWA standard C515, UL-262/FM-1120/1130, ULC - Underwriters' of Canada, and NSF Listed.

Available in either non-rising stem (NRS) or outside screw & yoke (OS&Y). NRS style is available with post plate for adaptation with an indicator post.

| | RATED PRESSURE | SEAT TEST PRESSURE | SHELL TEST PRESSURE |
|-------------------|----------------|--------------------|---------------------|
| AWWA 2" - 48" | 250 PSI | 250 PSI | 500 PSI |
| ULFM 2-1/2" - 12" | 200 PSI | 300 PSI | 500 PSI |
| ULFM 14" - 16" | 250 PSI | 375 PSI | 500 PSI |
| ULFM 18" - 24" | 200 PSI | 300 PSI | 500 PSI |

- 1 | 2"-12" C515 RSGV shall conform to the latest version of AWWA Standard C-515 covering Resilient Seated Gate Valves for Water Supply Service.
- 2 | The valves shall have a ductile iron body, and bonnet.
- 3 | The wedge shall be completely encapsulated with EPDM rubber.
- 4 | The sealing rubber shall be permanently bonded to the wedge to meet ASTM tests for rubber metal bond ASTM D249.
- 5 | Valves shall be supplied with O-Ring seals at all joints (no gaskets are used in the valve design).
- 6 | The valves shall be either non-rising or rising stem, opening by turning (left or right) and provided with 2" square operating nut or a handwheel with the "Open" and an arrow cast in the metal to indicate the direction to open.
- 7 | All stems shall operate with bronze stem nuts independent of stem (in NRS valves). NRS stems shall have (2) O-Rings located above thrust collar and (1) O-Ring below. All stem O-Rings shall be replaceable with valve fully opened and subjected to full pressure. The NRS stems shall also have (2) low torque thrust bearings located above and below stem collar to reduce friction during operation.
- 8 | OS&Y (rising stems) shall be of bronze. Pre-grooved stem for supervisory switch.
- 9 | Waterway shall be smooth, unobstructed & free of pockets, cavities, & depressions in the seat area. Valves shall be able to accept a full size tapping cutter.
- 10 | The body, bonnet, and stuffing plate shall be coated with fusion bonded epoxy, both interior and exterior on body and bonnet. Epoxy shall be applied in accordance with AWWA C550 and be NSF61 and NSF372 certified.
- 11 | Each valve shall have a maker's name, pressure rating, and year in which it was manufactured cast in the body. Prior to shipment from the factory, each valve shall be tested by hydrostatic pressure equal to requirements of both AWWA and UL/FM.
- 12 | All internal parts shall be accessible without removing the body from the line.
- 13 | Valves shall have all brass components cast and assembled in the USA and shall be manufactured by Kennedy Valve Company or equal.



KENNEDY VALVE

ORDERING INFORMATION

PH: 800-782-5831
607-734-2211

KNV.SALES@MCWANE.COM
WWW.KENNEDYVALVE.COM

KENNEDY VALVE

1021 E. WATER ST.
ELMIRA, NY
14902-1516



For Generations