



**KENNEDY VALVE**

# K17 INDUSTRIAL HYDRANT

## CERTIFICATIONS

ISO 9001

ISO 14001

BS OHSAS 18001



**PATENT # 9,260,840**

**PATENT # 9,260,844**

**PATENT PENDING**



[WWW.KENNEDYVALVE.COM](http://WWW.KENNEDYVALVE.COM)

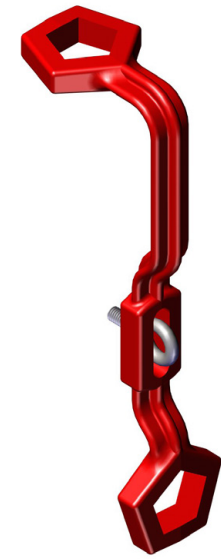
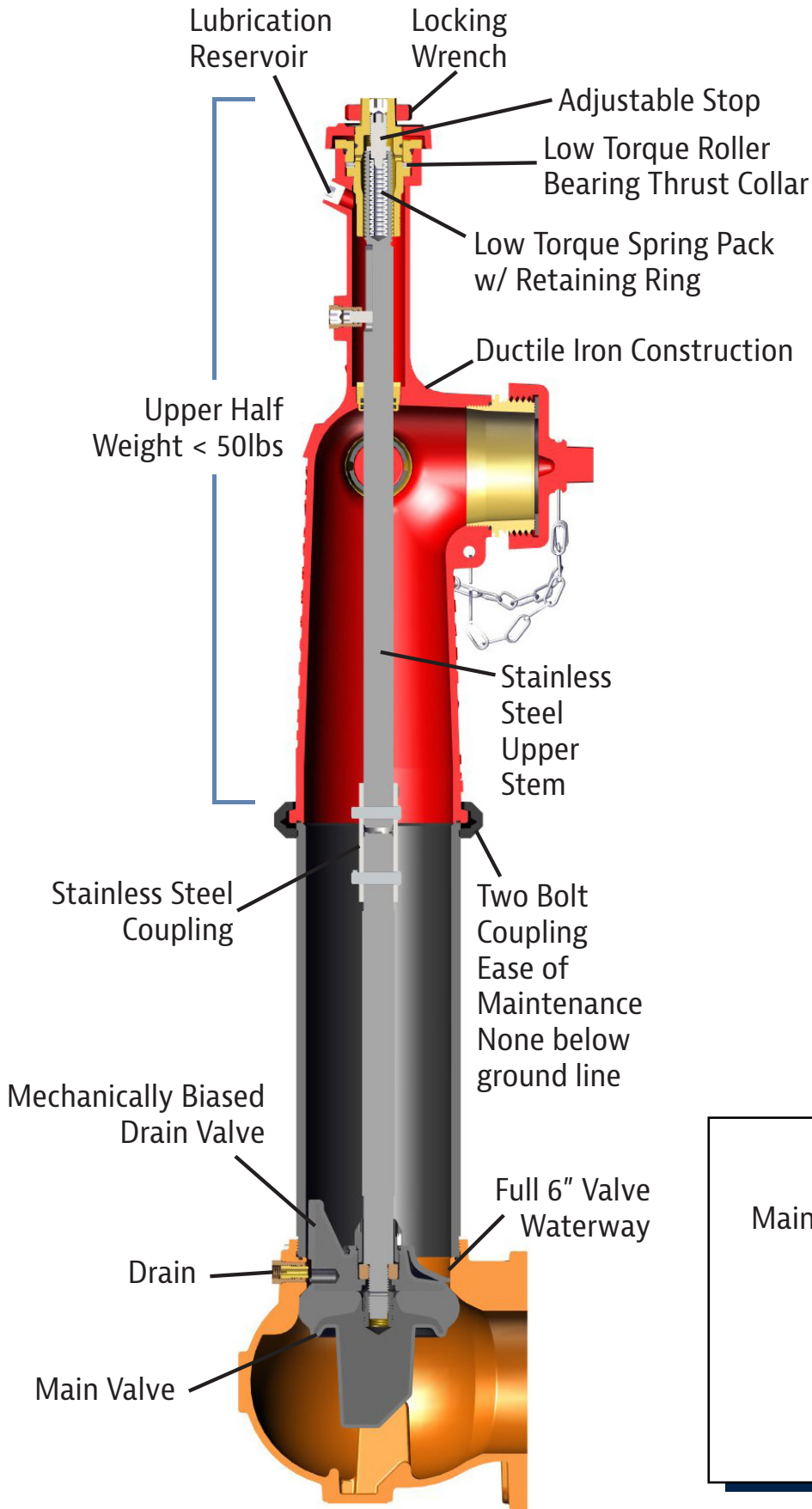

Locking Wrench  
(Handwheel Optional)



Collision Repair Kit

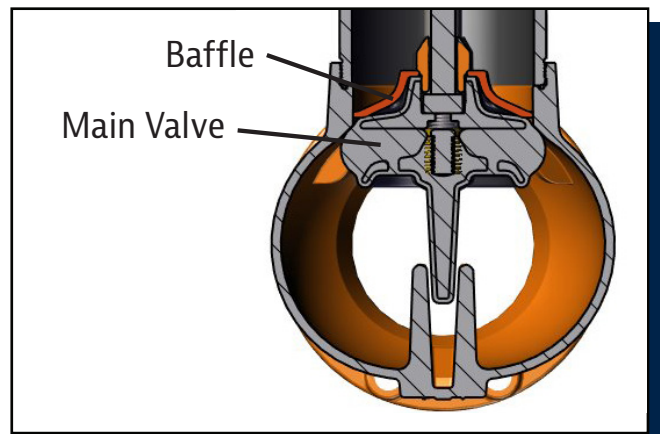

# HYDRANT PART LIST

# K17

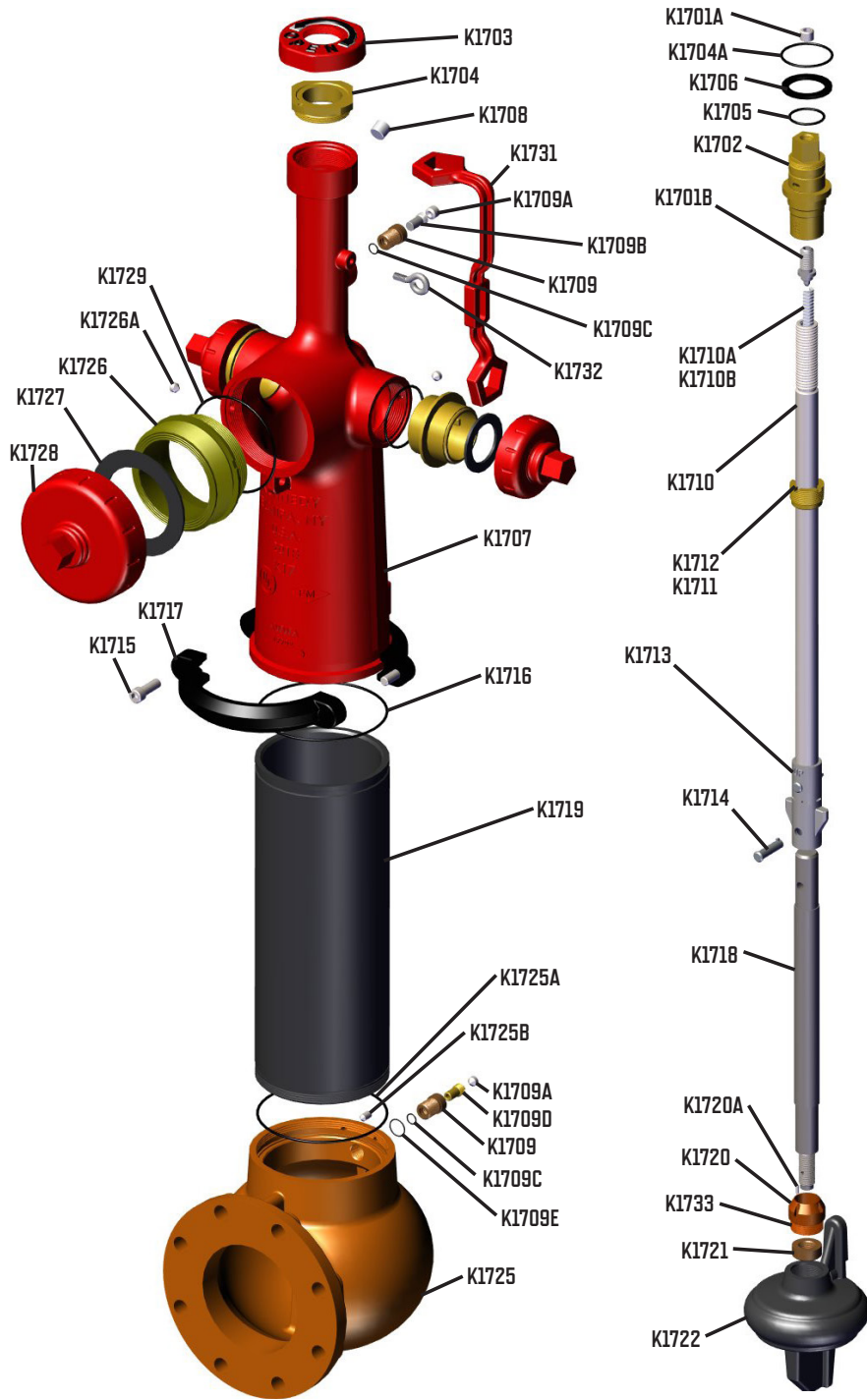

| CALLOUT | DESCRIPTION                               | MATERIAL ASTM  |
|---------|---|--|
| K1701A  | STEM LOCK SET SCREW                       | STAINLESS STEEL A276 (410)   |
| K1701B  | MAIN VALVE STOP                           | STAINLESS STEEL A276 (410)   |
| K1702   | OP NUT                                    | BRONZE B584 C86300/C86700  |
| K1703   | DIRT SHIELD                               | CAST IRON A126 Class B   |
| K1704   | LOCK NUT                                  | BRONZE B584 C87850   |
| K1704A  | O-RING                                    | BUNA-N RUBBER D2000  |
| K1705   | O-RING                                    | VITON D2000  |
| K1706   | ROLLER BEARING ASSEMBLY                   | STEEL  |
| K1707   | UPPER BARREL                              | DUCTILE IRON A536 GR. 70-50-05 or 65-45-12   |
| K1708   | 1/2" NPT PIPE PLUG                        | LOW CARBON STEEL   |
| K1709   | BUSHING                                   | NI-ALUMINUM BRONZE OR DUCTILE IRON B150 C63000 or A536 GR.70-50-05 or GR.65-45-12  |
| K1709A  | STEM PIN SET SCREW                        | STAINLESS STEEL A276 (410)   |
| K1709B  | STEM PIN                                  | STAINLESS STEEL A276 (410)   |
| K1709C  | O-RING                                    | BUNA-N RUBBER D2000  |
| K1709D  | ADJUSTABLE DRAIN VALVE                    | ALUMINUM BRONZE, MANGANESE BRONZE OR STAINLESS STEEL B150 C62300 or C62400; B138 C67300; A276 S30400; B505 C95400        |
| K1709E  | O-RING                                    | BUNA-N RUBBER D2000  |
| K1710   | UPPER STEM                                | STAINLESS STEEL A276 S30400 / S31600   |
| K1710A  | RETAINING RING                            | STEEL SAE 1070-1090 HIGH CARBON  |
| K1710B  | SPRING PACK                               | SPRING STEEL   |
| K1711   | O-RING                                    | BUNA-N RUBBER D2000  |
| K1712   | STEM BUSHING                              | DUCTILE IRON OR ALUMINUM BRONZE A536 GR. 70-50-05 or 65-45-12 PLATED; or B505 C95400                                     |
| K1713   | BREAKING COUPLING                         | STAINLESS STEEL A743 CA15 (410SS)  |
| K1714   | COUPLING PINS                             | STAINLESS STEEL 302HQ or 410SS   |
| K1715   | BARREL COUPLING BOLTS                     | STEEL (ZINC PLATED) A307 / SAE GR. 2 or 410SS  |
| K1716   | O-RING                                    | BUNA-N RUBBER D2000  |
| K1717   | BARREL COUPLING                           | DUCTILE IRON A536 GRADE 70-50-05   |
| K1718   | LOWER STEM                                | CRS OR STAINLESS STEEL A108 CRS or A276 S30400 or S31600   |
| K1719   | LOWER BARREL                              | DUCTILE IRON ANSI / AWWA C151 / A21.51   |
| K1720   | DRAIN VALVE RETAINING NUT                 | DI OR STAINLESS OR ALUMINUM BRONZE OR MANGANESE BRONZE A536 GR. 70-50-05 or 65-45-12; A276 S30400; B505 C95400 or C86300 |
| K1720A  | DRAIN NUT SET SCREW                       | STAINLESS STEEL  |
| K1721   | LOWER STEM COLLAR                         | ALUMINUM BRONZE OR STAINLESS STEEL B505 C95400 or A276 S30400  |
| K1722   | MAIN VALVE, ONE PIECE ENCAPSULATED RUBBER | EPDM RUBBER  |
| K1725   | ELBOW                                     | DUCTILE IRON A536 GRADE 70-50-05 / 65-45-12  |
| K1725A  | O-RING                                    | BUNA-N RUBBER D2000  |
| K1725B  | ELBOW SET SCREWS                          | STAINLESS STEEL 18-8   |
| K1726   | HOSE / STEAMER NOZZLE                     | BRONZE B584 C87850/C86700/C86300   |
| K1726A  | NOZZLE RETAINING SCREW                    | STAINLESS STEEL 18-8   |
| K1727   | NOZZLE GASKET                             | NEOPRENE D2000   |
| K1728   | NOZZLE CAP                                | CAST IRON A126 Class B   |
| K1729   | O-RING                                    | BUNA-N RUBBER D2000  |
| K1731   | WRENCH                                    | DUCTILE IRON A536 GRADE 70-50-05 / 65-45-12  |
| K1732   | EYE BOLT                                  | ZINC PLATED STEEL  |
| K1733   | BAFFLE                                    | DUCTILE IRON A536 GRADE 70-50-05 or 65-45-12   |

## K17 MONITOR



- 3" & 4" Monitor ANSI Flange Drilling
- Integrally Cast Monitor to Upper Barrel
- UL Approved & FM Listed
- Meets or exceeds AWWA C502
- Full flow 4 way openings: 4" monitor, 1 - 4-1/2 pumper nozzle, 2 - 2-1/2 hose nozzles
- Shoe interior epoxy coating meets AWWA C550

Shoe with choice of:

- 6" MJ
- 6" ANSI Flange
- Straight Shoe
- DN150

## K17 HYDRANT WITH STRAIGHT SHOE

- Allows for install in vertical pipeline
- Shares common components with standard shoe
- UL Approved & FM Listed
- Meets or exceeds AWWA C502

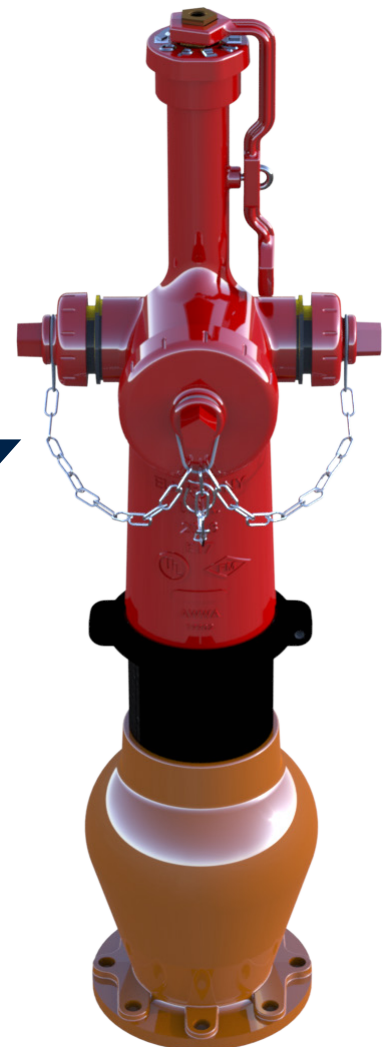

The Kennedy Valve 6" Main Valve K17 Hydrant is designed effectively for industrial applications. The K17 incorporates an adjustable main valve. This significant design advantage allows the K17 to have a higher CV rate than 5-1/4" hydrants. The pressure loss due to friction shall be less than 2.0 PSI at 1000 gpm through a 4-1/2" pumper nozzle. The number and size of nozzles, nozzle valves, base, or monitor connection to be per order or conform to the existing plant details previously established.

- 1] Low head loss, below 2 PSI at 1000 GPM
- 2] Full 6" diameter adjustable main valve
- 3] Security Locking wrench system
- 4] Only 2 bolts per hydrant. No bolts below ground line.
- 5] Meets or exceeds all applicable parts of AWWA C502, UL 246, & FM 1510
- 6] Integral Upper half < 50lbs., one man repair
- 7] Low torque to open collar roller bearing
- 8] Straight Shoe option
- 9] Adjustable stop at the top.
- 10] 350 PSI. Rated Pressure (2415 kPa)  
700 PSI. Test Pressure (4830 kPa)
- 11] Patent Pending\* Anti Cavitation Baffle
- 12] Spring Pack & Roller Bearing allow easy operation.

350 PSI RATED  
Low Head Loss < 2 PSI @1000 GPM  
Simplified Design  
(No Seat Ring or Bonnet)

Main Valve is adjustable for leakage correction or removal.

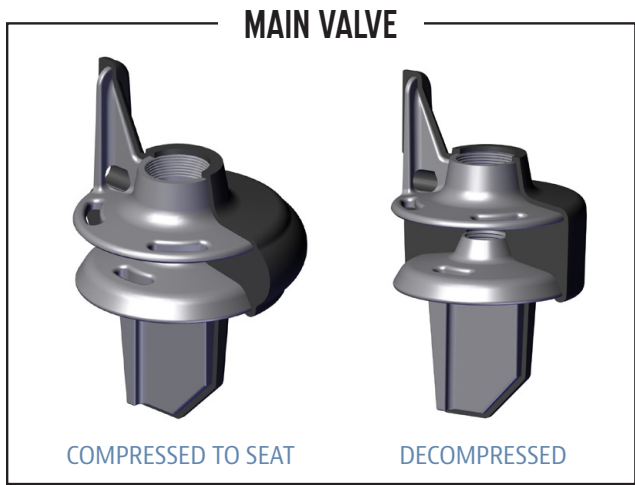

**K17 PRESSURE DROP V FLOW**

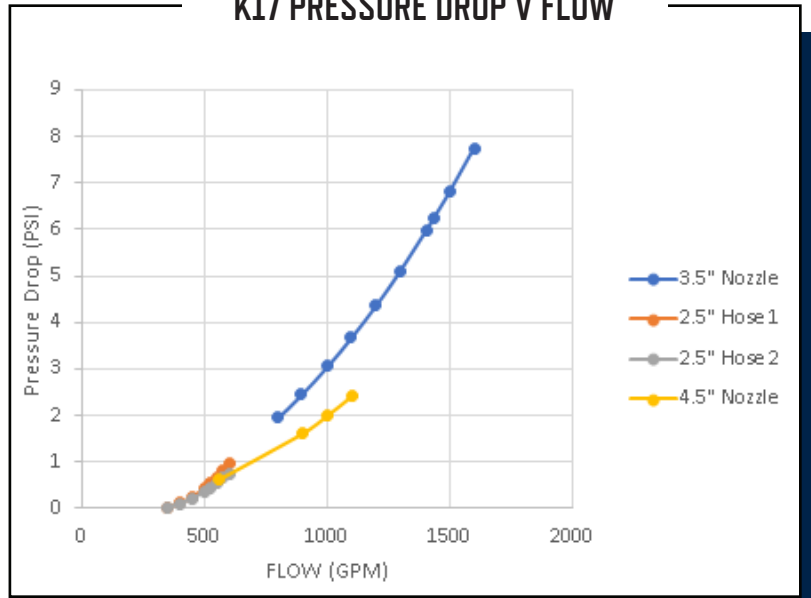

**WE PROUDLY SERVE**



**PETROLEUM OIL & GAS**



**MANUFACTURING**



**AIRCRAFT HANGARS**



**CHEMICAL PLANTS**



**KENNEDY VALVE**

**ORDERING  
INFORMATION**

**PH:** 800-782-5831  
607-734-2211  
**FAX:** 800-952-4771

[SALES@KENNEDYVALVE.COM](mailto:SALES@KENNEDYVALVE.COM)  
[WWW.KENNEDYVALVE.COM](http://WWW.KENNEDYVALVE.COM)

**KENNEDY VALVE**

1021 E. WATER ST.  
ELMIRA, NY  
14902-1516



For Generations